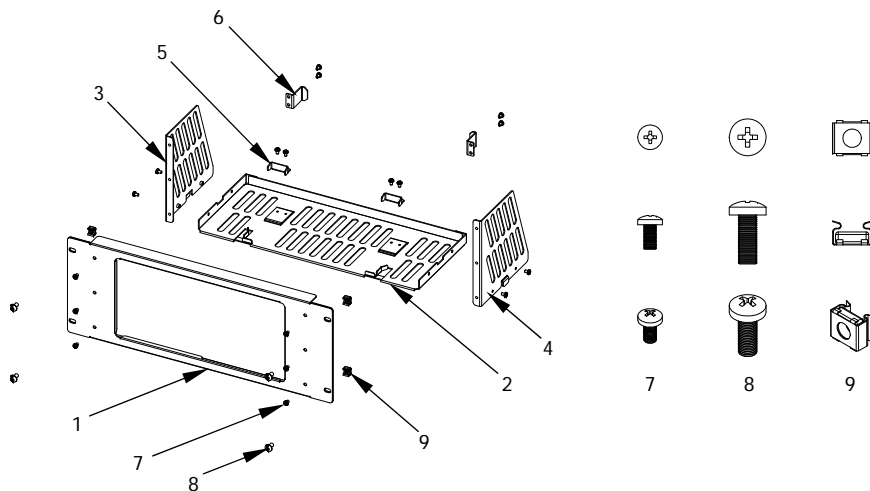

RIGOL**Rack Mount Kit****MSO1000Z/DS1000Z/DG4000**

This rack mount kit is designed to mount **RIGOL** MSO1000Z/DS1000Z series digital oscilloscope or DG4000 series function/arbitrary waveform generator into a 19-inch machine cabinet that conforms to the Electronic Industries Association (EIA) standard. This manual takes DG4000 as an example to introduce the installation method.

Kit Part Checklist

No.	Name	Qty.	Description
1	Front Plate	1	--
2	Bottom Plate	1	--
3	Left Plate	1	--
4	Right Plate	1	--
5	Retaining Bracket	2	--
6	Fastener	2	--
7	M4 Screw	18	M4×8 Phillips Pan Head Screw
8	M6 Screw	4	M6×16 Phillips Pan Head Screw
9	M6 Nut	4	M6 Square Lock Cage Nut

**Installation Tool**

The PH2 Phillips screwdriver is recommended.

Space Requirements

To mount the instrument into the cabinet correctly, please ensure that the following requirements are met.

- The cabinet must be a standard 19-inch one.
- The available height of the cabinet should be at least 4U (177.8 mm).
- The depth of the cabinet should be at least 400 mm.

The dimensions of the rack-mounted instrument are as shown below.

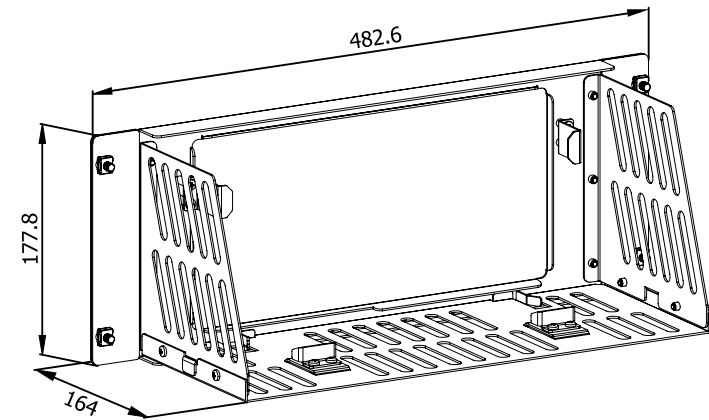

Unit: mm

Installation Procedures



CAUTION

Only authorized operators are allowed to perform the installation. Improper installation might cause damage to the instrument or an installation failure.

1. Mount the left and right plates

Align the detents of the left and right plates with the openings on both sides of the bottom plate respectively and insert them into the bottom plate, then fasten them using four M4 screws.

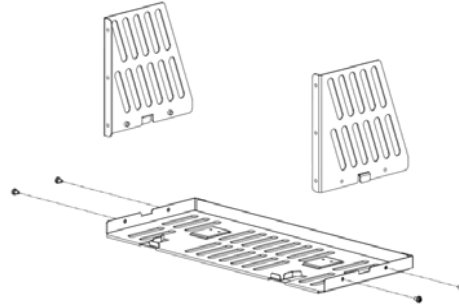

2. Mount the front plate

Attach the front plate to the assembled shelf, then secure the front plate with six M4 screws.

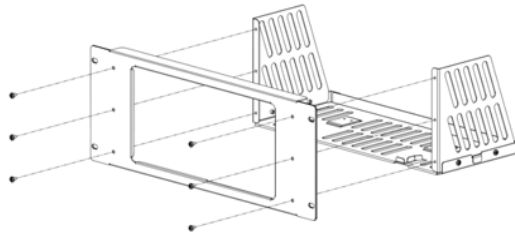

3. Fasten the lower part of the instrument

Place the instrument onto the bottom plate and secure the rear feet of the instrument with two retaining brackets, then use four M4 screws to fasten brackets.

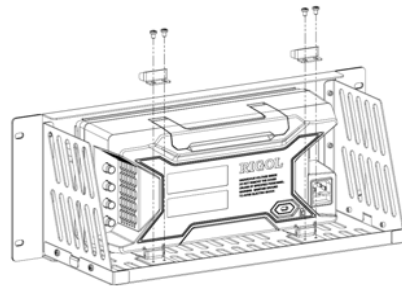

4. Fasten the upper part of the instrument

Fasten the upper part of the instrument with two fasteners, then secure them with four M4 screws.

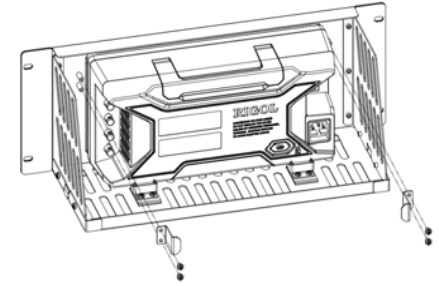

5. Get encased in the cabinet

Mount the assembled instrument and rack into a standard 19-inch cabinet using four M6 screws and four M6 square nuts.

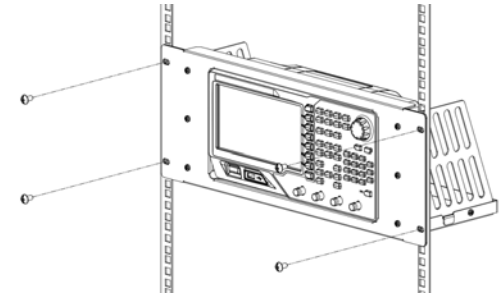

-End-